

03

Height Safety  
Lifting  
Load Control  
Safety Management



**NEW!**

MaXafe Heavy-Duty Lashing  
**Ensuring heavy loads  
arrive safely!**

SpanSet  
Certified  
Safety



# MaXafe advantages

## Extremely low expansion of less than 2 %



High-performance webbing fibres ensure an exceptionally low expansion of less than 2 % - comparable to wire ropes or chains. **The advantage:** During emergency braking or evasive manoeuvres, the forces are applied directly to the lashing system thereby reducing slippage of heavy goods to a minimum.

## Improved ergonomics



Thanks to the use of high-performance polyester, the approx. 50 mm wide MaXafe webbing already achieves the strength of a 75 mm wide polyester belt of conventional heavy duty ratchets. **The advantage:** Weight savings of about 24 % compared to a 75 mm lashing belt or similar chain offers a significant reduction in workload. MaXafe is handy and quick to install.

## Robust webbing construction



The webbing design of the MaXafe Heavy Duty Lashing System is particularly resistant through the use of high-performance fibres, reducing webbing abrasion and cut injuries to the fabric. **The advantage:** Longer service life and lower costs.

## Quality label with foil sleeve

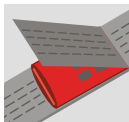

The MaXafe heavy-duty lashing's labels feature a strong and tear-proof design. Foil sleeve and webbing overlap also protect the label from dirt and abrasion. **The advantage:** Guaranteed long life.

## Machined seam

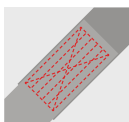

The machined seam is precise and of high, consistent quality. The black seam thread contrasts strongly with the light green belt, which makes visual inspection much easier and faster. **The advantage:** Reduction of cost and effort.

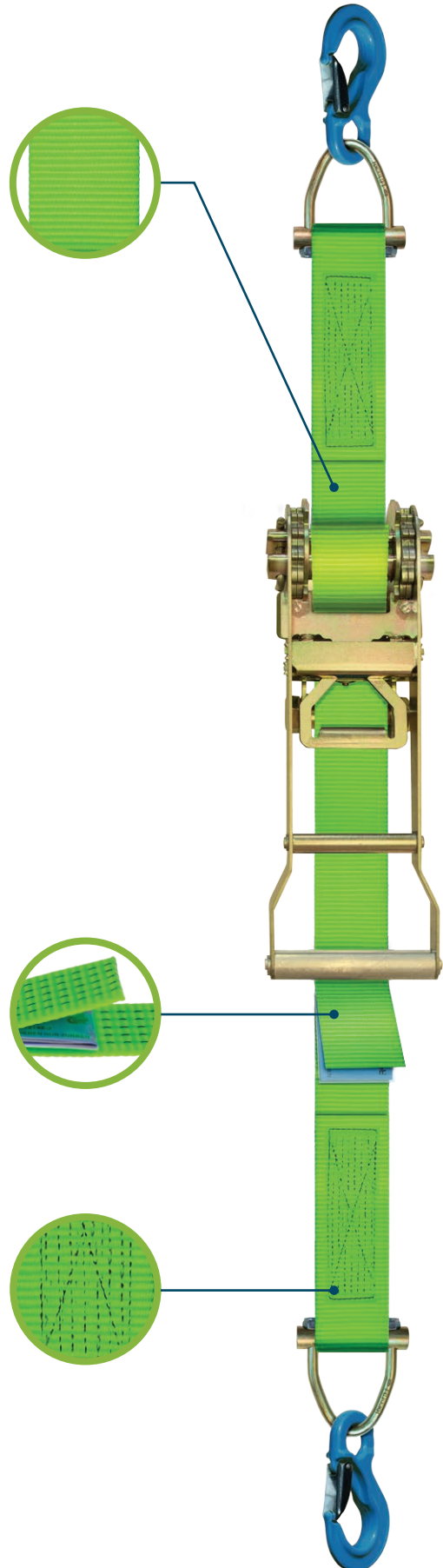



# MaXafe

MaXafe Heavy-Duty Lashing  
So that heavy loads  
arrives safely!



## Design

Ideal for transverse and diagonal lashing of heavy vehicles and machines

MaXafe is available to the user in two systems:

The one-piece lashing belt designed according to the Carlash system principle is equipped with triangle and **A** snap hooks and has a permissible lashing capacity of 10,000 daN. The two-piece version, with either **A** snap hook (SFH) or **B** ExoSet triangle hook (LS) at the loose and fixed ends, has a permissible lashing capacity of 5,000 daN. Both lashing systems are ideal for transverse / diagonal lashing.

### One-piece (Carlash-System)

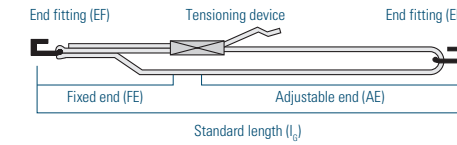

Item No.	EF	Design	LC* [daN]	l <sub>e</sub> [m]	Belt width [mm]	Belt thickness [mm]	Expansion [%]	ca. System weight [kg]
D076503	LS	one piece	10,000	3	55	3	< 2	10,3
D076504	LS	one piece	10,000	4	55	3	< 2	10,6

\* Lashing Capacity

### Two-piece

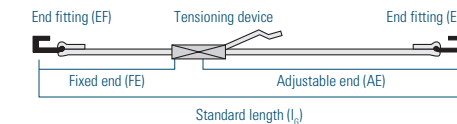

Item No.	EF	Design	LC* [daN]	l <sub>e</sub> [m]	Belt width [mm]	Belt thickness [mm]	Expansion [%]	ca. System weight [kg]
D076498	2 x SFH	two piece	5,000	3	55	3	< 2	4,5
D076501	2 x LS	two piece	5,000	3	55	3	< 2	6,5
D076500	2 x SFH	two piece	5,000	4	55	3	< 2	4,7
D076502	2 x LS	two piece	5,000	4	55	3	< 2	6,7

\* Lashing Capacity

**A** SFH – snap hook    **B** LS – ExoSet triangle hook



### Applications

SpanSet MaXafe was specially developed for the transport of heavy machinery and vehicles in the construction, agricultural and machine industries.

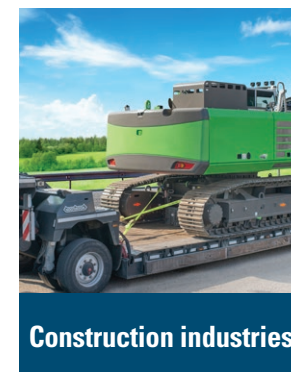

Construction industries



Agricultural industries



Machine industries



### Material properties

Operating temperature : – 40 to 100 °C  
 Belt material: PES / high-performance fibre  
 Belt width: 55 mm  
 Belt thickness: 3 mm  
 Belt length: variable  
 Belt colour: neon green  
 Expansion: < 2 %  
 Standard: DIN EN 12195-2  
 Clamping element: yellow-chromated  
 ExoSet triangle hook: painted (blue)  
 Carabiner hook: yellow-chromated

### Dimensions of fasteners

One piece (Carlash-System)

**B** LS – ExoSet triangle hook LC: 10,000 daN

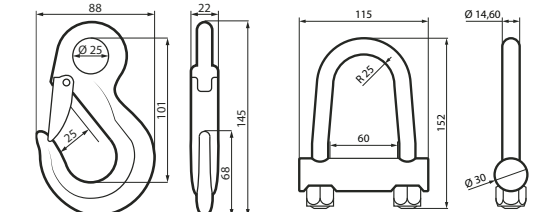

Two piece

**A** SFH – snap hook LC: 5,000 daN

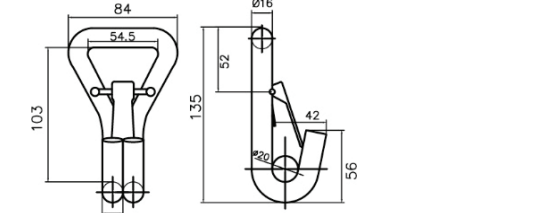

**B** LS – ExoSet triangle hook LC: 5,000 daN

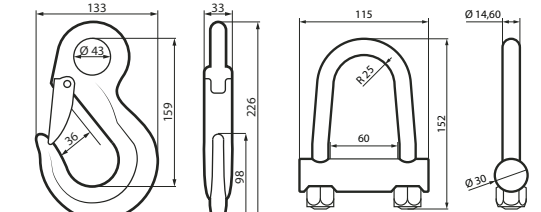

### Optional accessories:

- Individual lengths
- Optional printed webbing
- Abrasion protection coating (PVC/PU)

Get in touch, we're happy to help!



